

INSTALLATION INSTRUCTIONS

TAURUS SITE 110V 8W LED BULKHEADS
Product Codes: **TAC8Y, TA08Y & TAR8Y**

Safety Warning



- The installation should be carried out by a qualified electrician in compliance with the current edition of the IEE Wiring Regulations.
- Prior to installation, carry out the necessary risk assessment considering the people who could be at risk, the level of risk and the precautions required to control the risk
- Ensure that the circuit supply is isolated either by the circuit supply fuse being removed or the applicable circuit breaker being turned off before installation or any maintenance.
- Check the total load on the circuit ensuring the luminaire does not exceed the rating of the circuit cable, fuse or circuit breaker.
- Long-term use and voltage fluctuations can reduce the life span of the fitting.
- If the fitting incorporates control gear, ensure careful sizing to avoid instances of nuisance tripping of the protective device used in the installation.
- Follow the provided installation instructions, using the fixings supplied or recommended.
- Keep out of reach of children.



Specification

Box Contents -
1 x Taurus Site 110V 8W LED Bulkhead

Dimensions:	L: 245 x W: 125 x D: 97mm
Material:	Polycarbonate
Working Temperature:	-10°C - 40°C
Included:	Accessory Kit - 4x fixing screws and wall plugs, blind grommet.

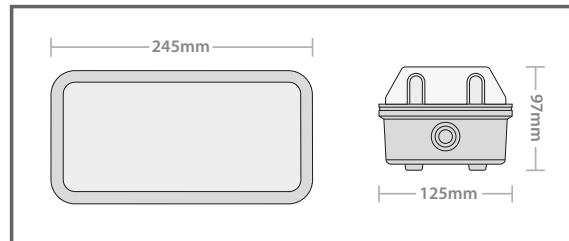

*Not applicable to red diffuser version

MAXIMUM FITTINGS PER CIRCUIT

Automatic Circuit Breaker Type:	B6	B10	B13	B16	B20	C10	C13	C16	C20
Rated Current:	6A	10A	13A	16A	20A	10A	13A	16A	20A
Cable (mm):	1.5	1.5	1.5	1.5	2.5	1.5	1.5	1.5	2.5
TAURUS SITE 110V 8W LED BULKHEAD	12	20	26	32	40	40	52	64	80

Installation Instructions

1. Select the preferred installation position and check to ensure there are no obstructions, pipes or concealed cables before drilling any fixing holes.
2. Remove the diffuser from the bulkhead by loosening the retaining screws.
3. Loosen the retaining screws on the gear tray and remove from the bulkhead.
4. Select one of the cable entry points on the back or sides of the base and drill through.
5. Feed the supply cable through the hole, sealing the entry by using the grommet supplied or a suitable cable gland to retain the IP rating.

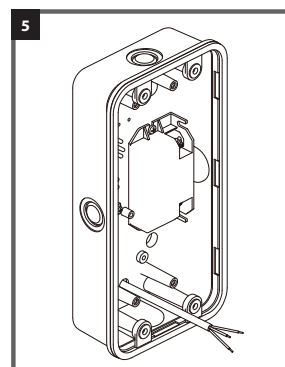
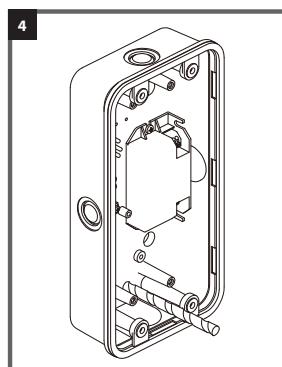
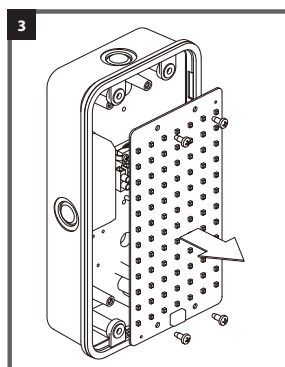
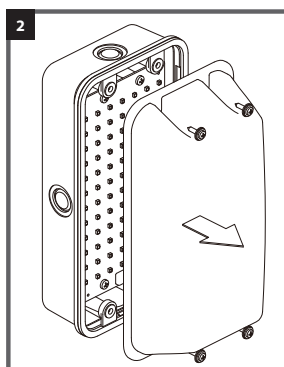

6. Position and fix the base to the mounting surface, using the screws provided at the four fixing positions.

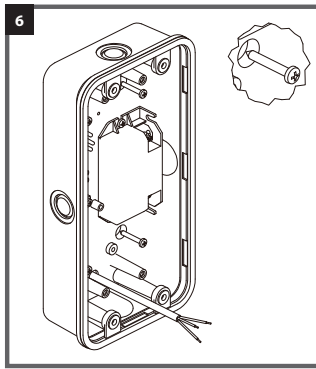

7. Terminate the supply cable into the terminal block on the rear of the gear tray, observing correct polarity. Ensure all conductors are fully sleeved and insulated against heat. This fitting is Class II Double Insulated. No earth connection is required.

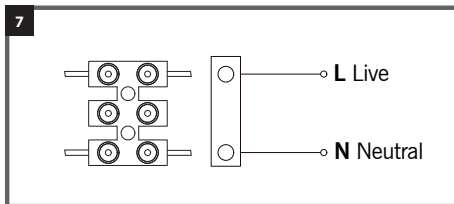

8. Replace the gear tray and tighten the retaining screws.
9. Replace the diffuser and tighten the retaining screws, ensuring no cables are trapped.

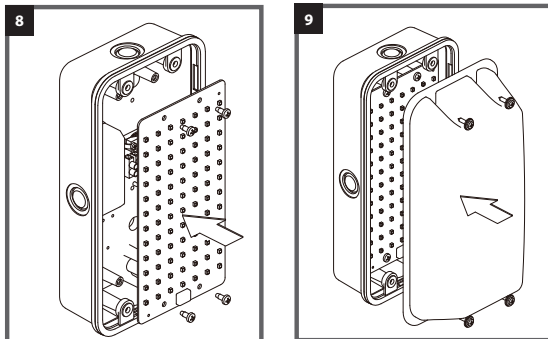

10. Restore the power supply and check for correct operation.

Notes

- Optional extra deep prismatic diffusers are available for this product (order separately product code TA/CLEAR : clear prismatic or TA/RED: red prismatic). To fit these optional diffusers, remove diffuser retention screws from the diffuser supplied and use to fix the new diffuser in place (step 9)
- An optional neat black trim attachment is also available, product code TA/TRIM (order separately). This clips over the diffuser after fixing. Not suitable for use with extra deep prismatic diffusers

Guarantee

This product is guaranteed for a period of 3 years from the date of purchase. The guarantee is invalid in the case of improper use, tampering, removal of the Q.C. date label, installation in an improper working environment or installation not according to the current edition of the I.E.E. Wiring Regulations (BS7671). The guarantee is also invalidated if the luminaire has been insulation tested. Should this product fail during the guarantee period it will be replaced free of charge, subject to correct installation and return of the faulty unit. We do not accept responsibility for any installation costs associated with the replacement of this product. Your statutory rights are not affected. We reserve the right to alter specifications without prior notice.

Maintenance

- This fitting will require routine cleaning if used in adverse (dust, paint, welding, oils etc) environments. Do not use solvents, aggressive detergents or abrasives.
- The LEDs and Driver in this product can be replaced at the end of life. This must be carried out by a professional, competent person.

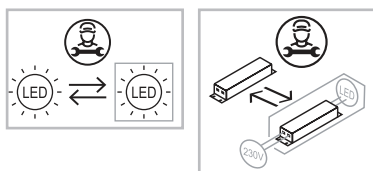

- When this fitting comes to the end of its life or you choose to replace it, please do not dispose of it with your normal waste. Please recycle where the facilities exist, check with your local authority for suitable options.

INS/SITE/0017/TA/V2